

EXPOLIGHT CURVE PODIUM ASSEMBLY



Expo EXPO Displays
A Division of Diamond Displays International

3401 Mary Taylor Road
Birmingham, Alabama 35235
(205) 439-8200

Drawn By: CASS

Project Title

Sheet Title

**ASSEMBLY
INSTRUCTIONS**
**EXPOLIGHT®
ASSEMBLY**

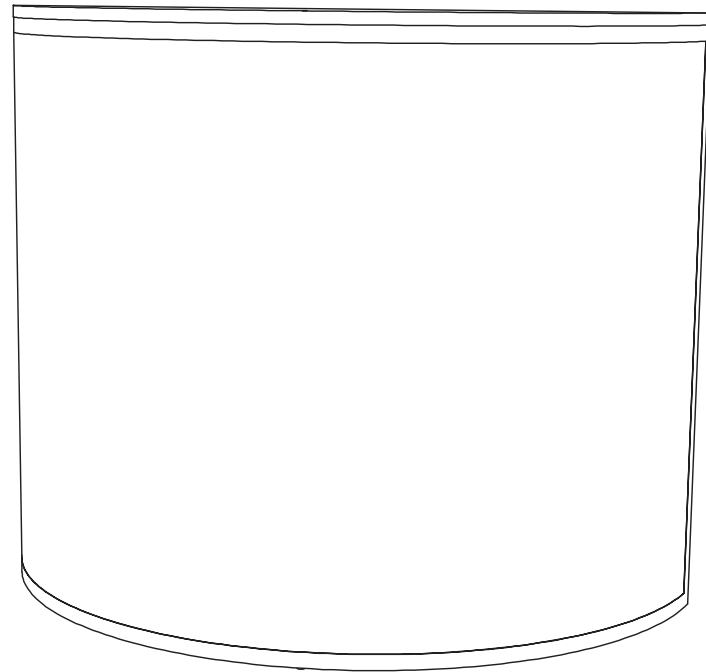

PARTS NEEDED :

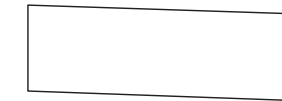
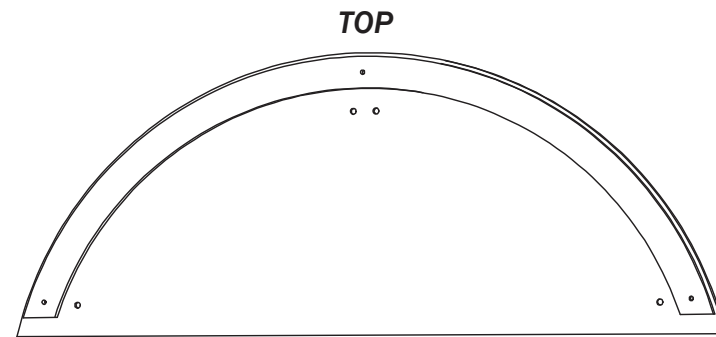

STORAGE SHELF

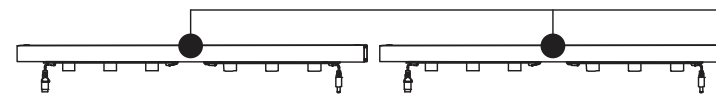

(2)
LIGHTBAR(S)

BACKLIT
GRAPHIC

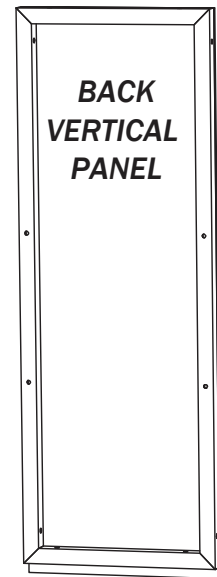
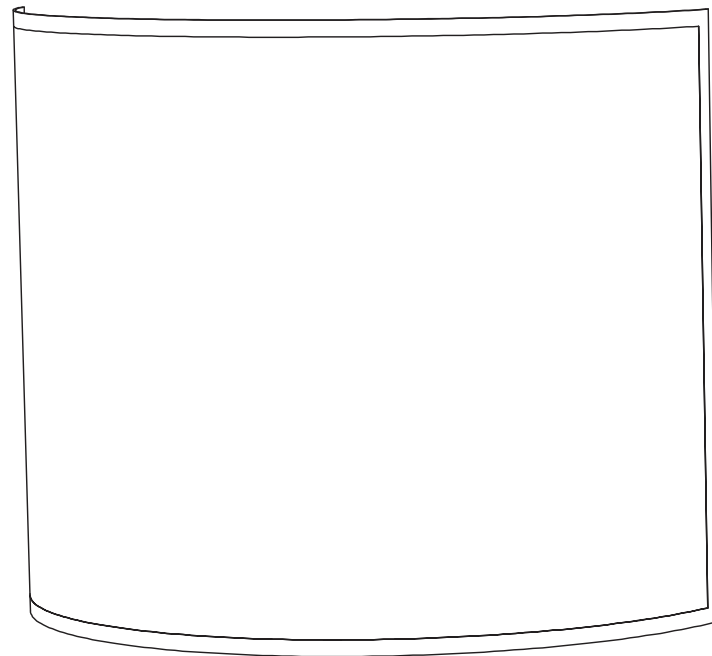

BACK
VERTICAL
PANEL

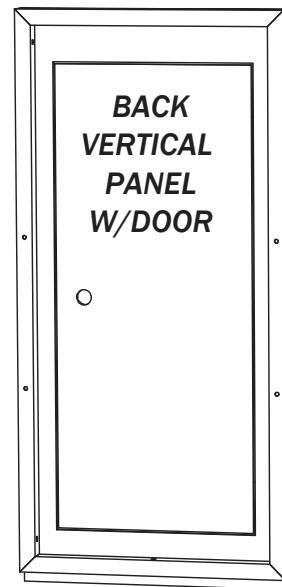

BACK
VERTICAL
PANEL
W/DOOR

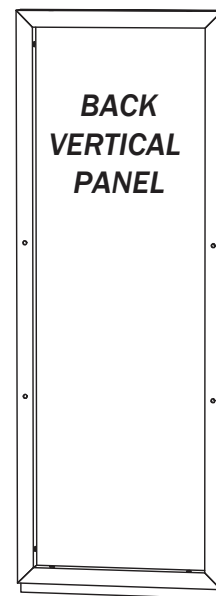

BACK
VERTICAL
PANEL

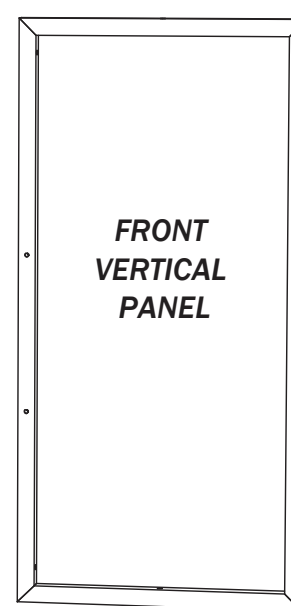

FRONT
VERTICAL
PANEL

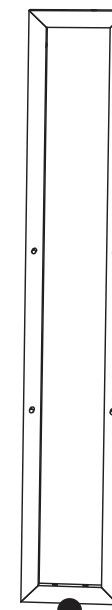
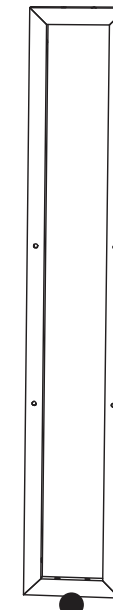

(2)
SIDE PANEL(S)

RED THUMBSCREWS

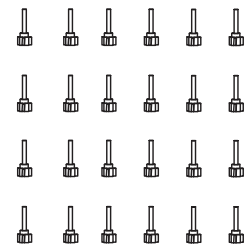

SHELF PEGS



POWER CORD & TRANSFORMER

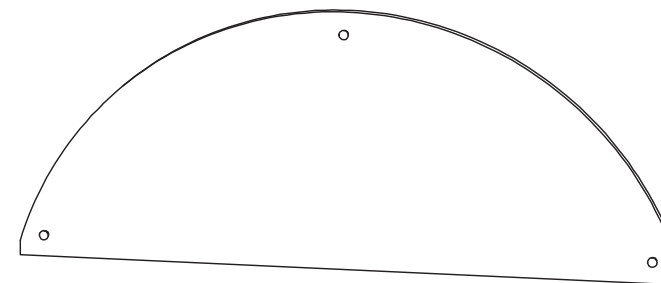
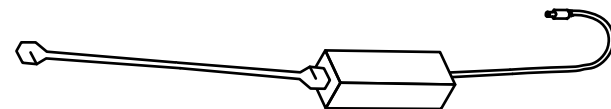

BOTTOM WITH FEET

EXPOLIGHT CURVE PODIUM ASSEMBLY

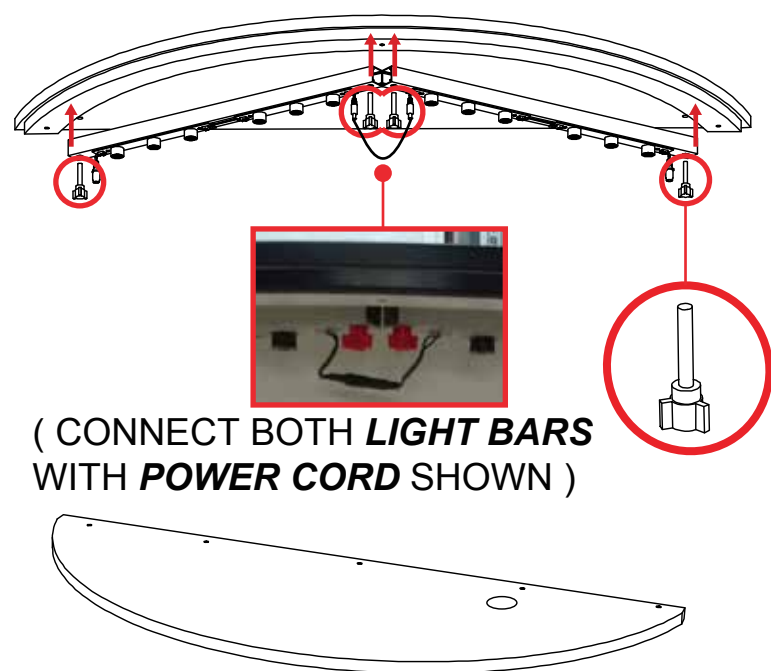

(CONNECT BOTH **LIGHT BARS** WITH **POWER CORD** SHOWN)

STEP 1

MATCH NUMBERS TO CONNECT (4) **16" LIGHTBARS** TO **BOTTOM AND TOP** WITH (8) **RED THUMBSCREWS**

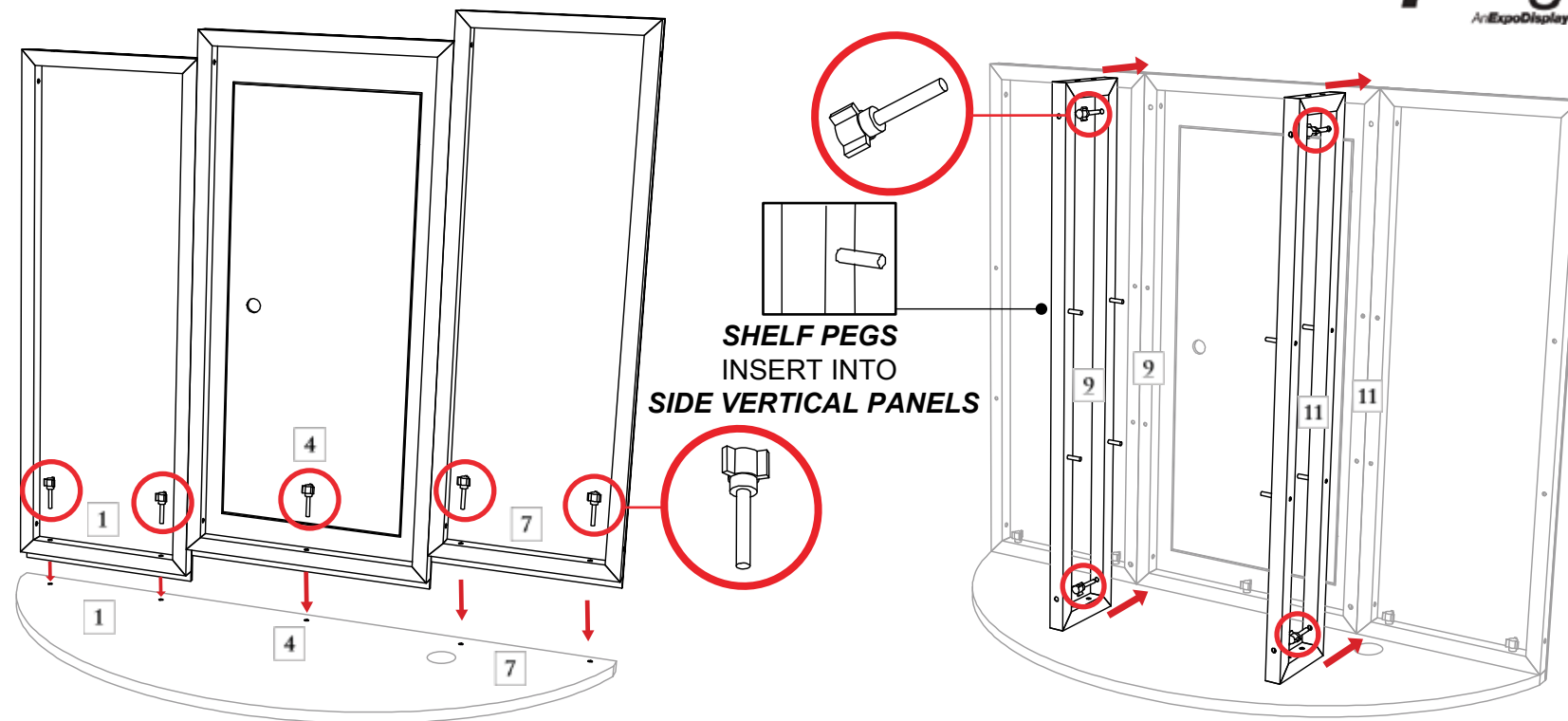

SHELF PEGS
INSERT INTO
SIDE VERTICAL PANELS

STEP 2

MATCH NUMBERS TO CONNECT (3) **BACK VERTICAL PANELS** TO **BOTTOM** WITH (5) **RED THUMBSCREWS**

STEP 3

MATCH NUMBERS TO CONNECT (2) **SIDE VERTICAL PANELS** TO **BACK** WITH (4) **RED THUMBSCREWS**

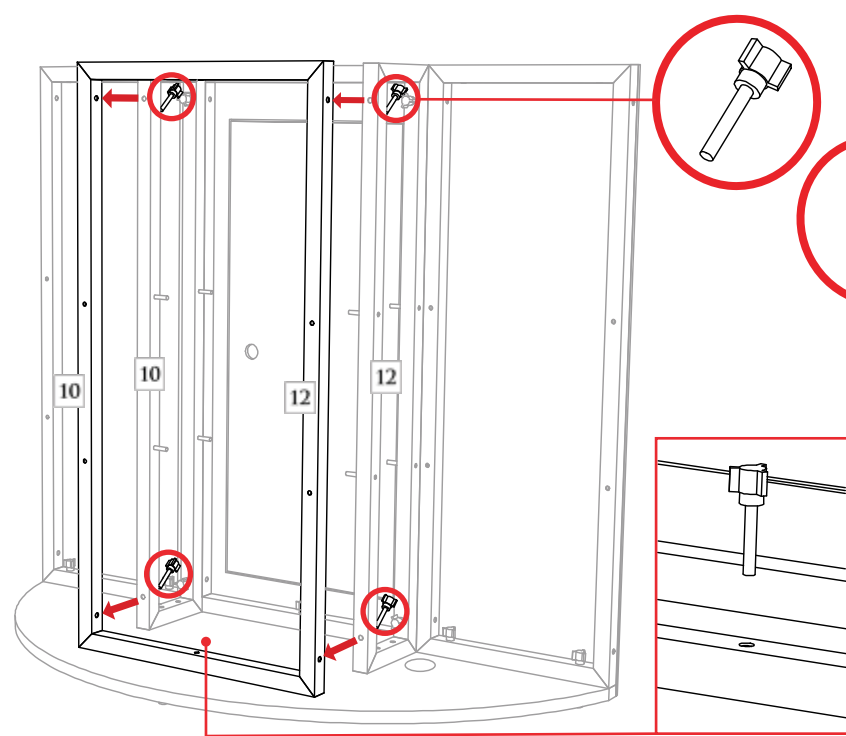

STEP 4

MATCH NUMBERS TO CONNECT (1) **FRONT VERTICAL PANEL** TO **SIDE PANELS** WITH (5) **RED THUMBSCREWS**

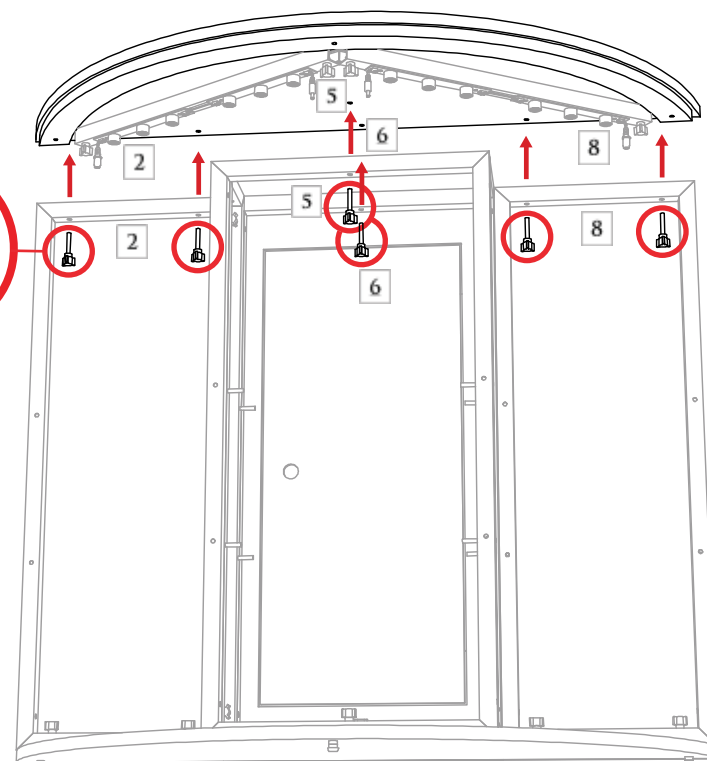

STEP 5

MATCH NUMBERS TO CONNECT (1) **TOP TO VERTICAL FRAMES** WITH (6) **RED THUMBSCREWS**

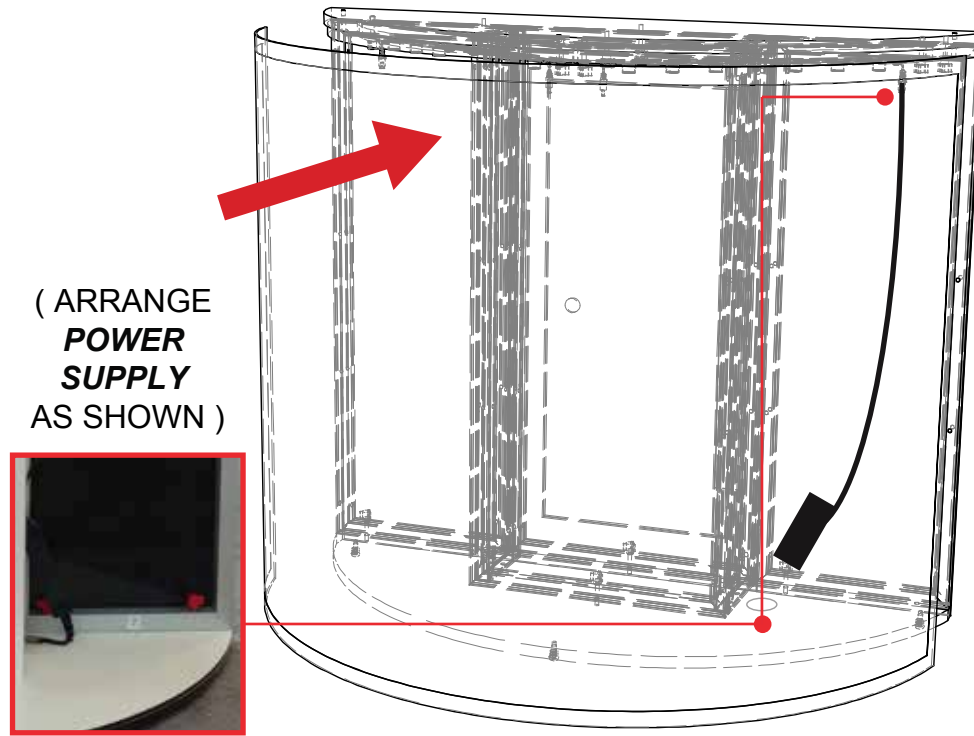

(ARRANGE **POWER SUPPLY** AS SHOWN)

STEP 6

CONNECT **POWER SUPPLY** THEN ATTACH **MAGNETIC CURVED BACKLIT GRAPHIC**



Expo EXPO Displays
A Division of Diamond Displays International

3401 Mary Taylor Road
Birmingham, Alabama 35235
(205) 439-8200

Drawn By: CASS

Project Title

Sheet Title

ASSEMBLY INSTRUCTIONS
EXPOLIGHT® ASSEMBLY